

HDI 100 Series



Quick Start Guide



LMI TECHNOLOGIES

15197-1.2_MANUAL_Quickstart_HDI-100-Series-Master-100.pdf

Getting Started with the HDI 100 Series 3D Scanner

Congratulations on purchasing the HDI 100 Series 3D Scanner. This quick start guide provides you with the resources to get you started on 3D scanning.

The HDI 100 Series 3D Scanner comes with:

- 3D scanning software, FlexScan3D
- Physical capturing unit for capturing 3D data (some assembly is required)

Downloading FlexScan3D Software

The HDI 100 Series 3D Scanner is powered by FlexScan3D software. The online support center (user.lmi3d.com) contains information related to downloading FlexScan3D. To create a download account, please send your contact name, email address, and company name to orders@lmi3d.com.

Instructions for installing and activating FlexScan3D using installation ID or dongle can be found in the FlexScan3D User's Guide under "Getting Started": <http://manual.lmi3d.com>.

Assembling the Capturing Unit

Instructions for assembly can be found in this Quick Start Guide.

Customer Support

If you have any installation issues, please contact:

Worldwide

Email:

support@lmi3d.com

Web:

www.lmi3d.com

North America

Phone:

+1 604 636 1011

Europe

Phone:

+31 45 850 7000

Hardware included with your HDI 100 Series Scanner

NOTE: Refer to the FlexScan3D User's Guide for information on installing and using the FlexScan3D software at <http://manual.lmi3d.com>.



When you receive your HDI 100 Series 3D Scanner, check that these items are included:

1	HDI 100 Series Scanner, Blue LED
2	Table-top Tripod
3	5m Power/Ethernet to Master cordset, 90-degrees, 2xRJ45 ends
4	5m Sensor Trigger cordset, open wire end
5	Master 100
6	Master 100 Power Supply

Set up the Table-top Tripod and mount the Scanner

- Spread the **Table-top Tripod** ② legs and place them on a flat, stable surface.
- Attach the **HDI 100 Series Scanner** ① to the **Table-top Tripod** head by hand-tightening the head knob.



Connect the Cordsets to the Scanner

- Connect the **Power/Ethernet to Master Cordset** ③ to the Power/LAN connector on the **Scanner** ①.
- If you wish to use the Master 100 Trigger button to trigger the scanner, connect the **Sensor Trigger Cordset** ④ to the I/O connector on the **Scanner** ①.
- Hand-tighten both cordsets.



Connect the Power/Ethernet to Master Cordset to the Master 100

- Plug the Power/Sync (black cord) RJ45 end of the **Power/Ethernet to Master Cordset** ③ to the Power port on the **Master 100** ⑤.
- Plug the Ethernet (yellow cord) RJ45 end of the **Power/Ethernet to Master Cordset** ③ to the Ethernet port on the **Master 100** ⑤.

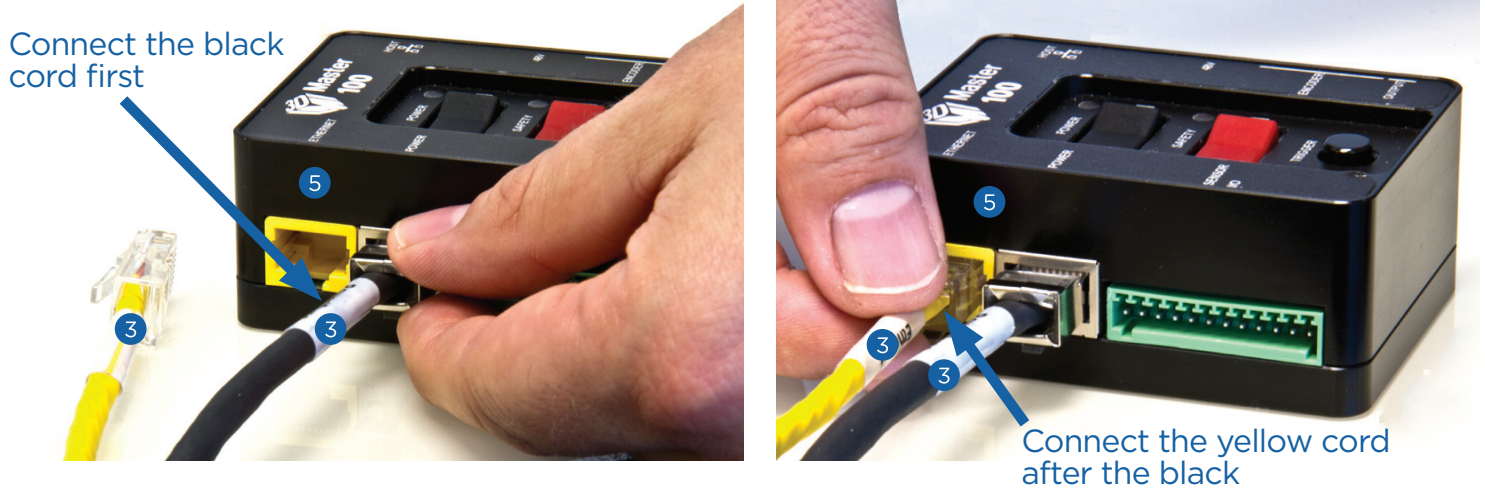

Connect the Sensor Trigger Cordset to the Master 100

- If you wish to use the Master 100 Trigger button to trigger the scanner, connect the green connector end of the **Sensor Trigger Cordset** ⑤ to the Sensor I/O port on the **Master 100** ④.

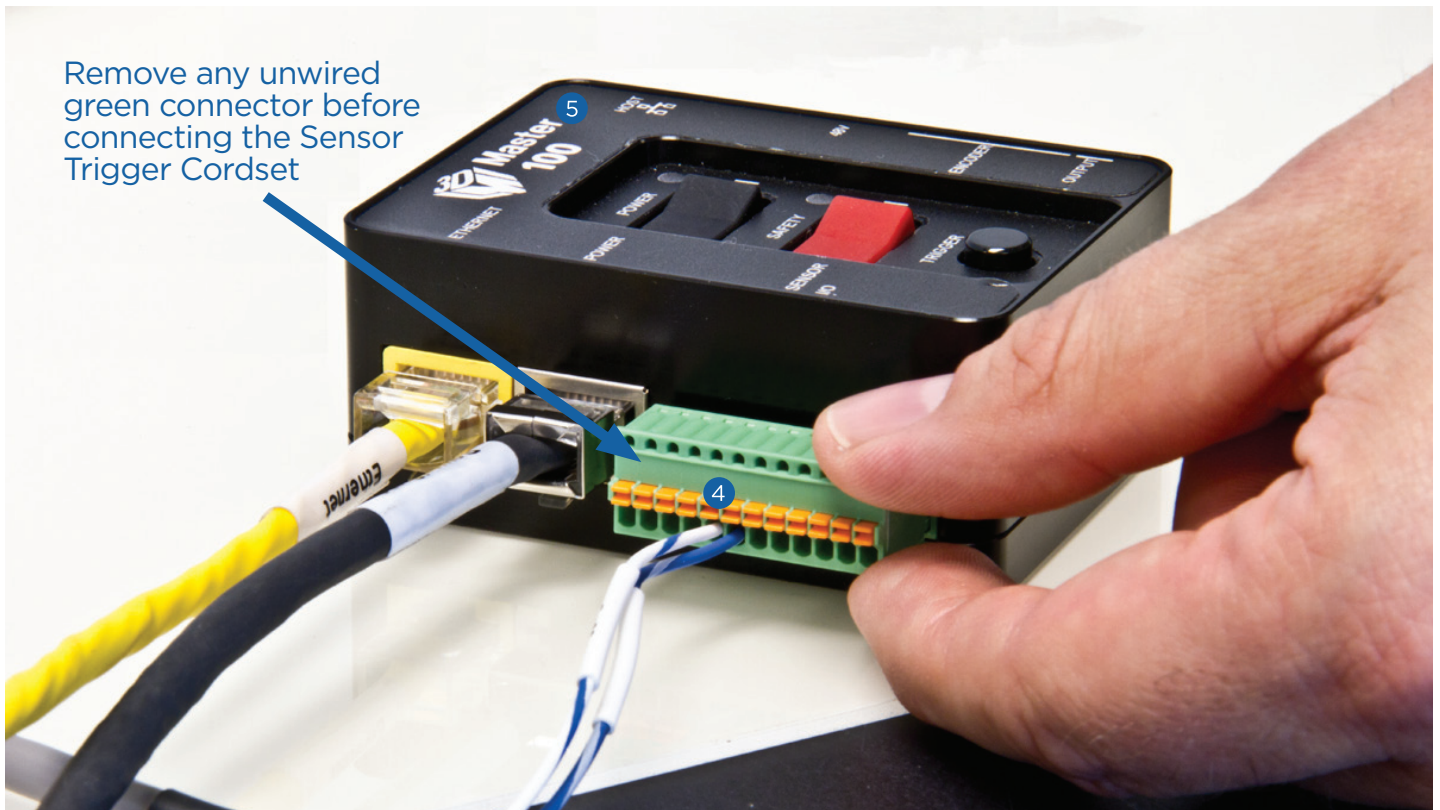

Connect the Master 100 Power Supply

- Connect the **Master 100 Power Supply** ⑥ to the 48V port on the **Master 100** ⑤.
- Plug the **Master 100 Power Supply** ⑥ power cable into an electrical outlet.

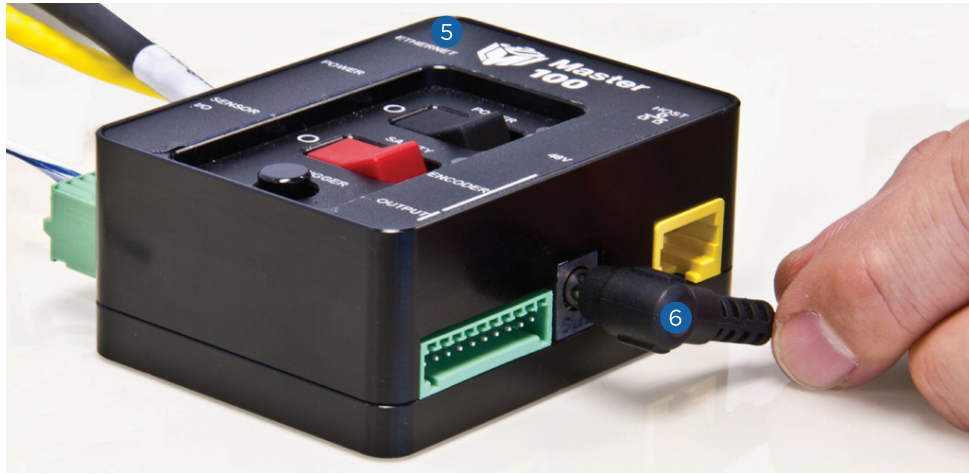

Connect the Master 100 to your computer

- Connect the Host port on the **Master 100** ⑤ to your computer's Ethernet jack using a CAT5e cable (not supplied).

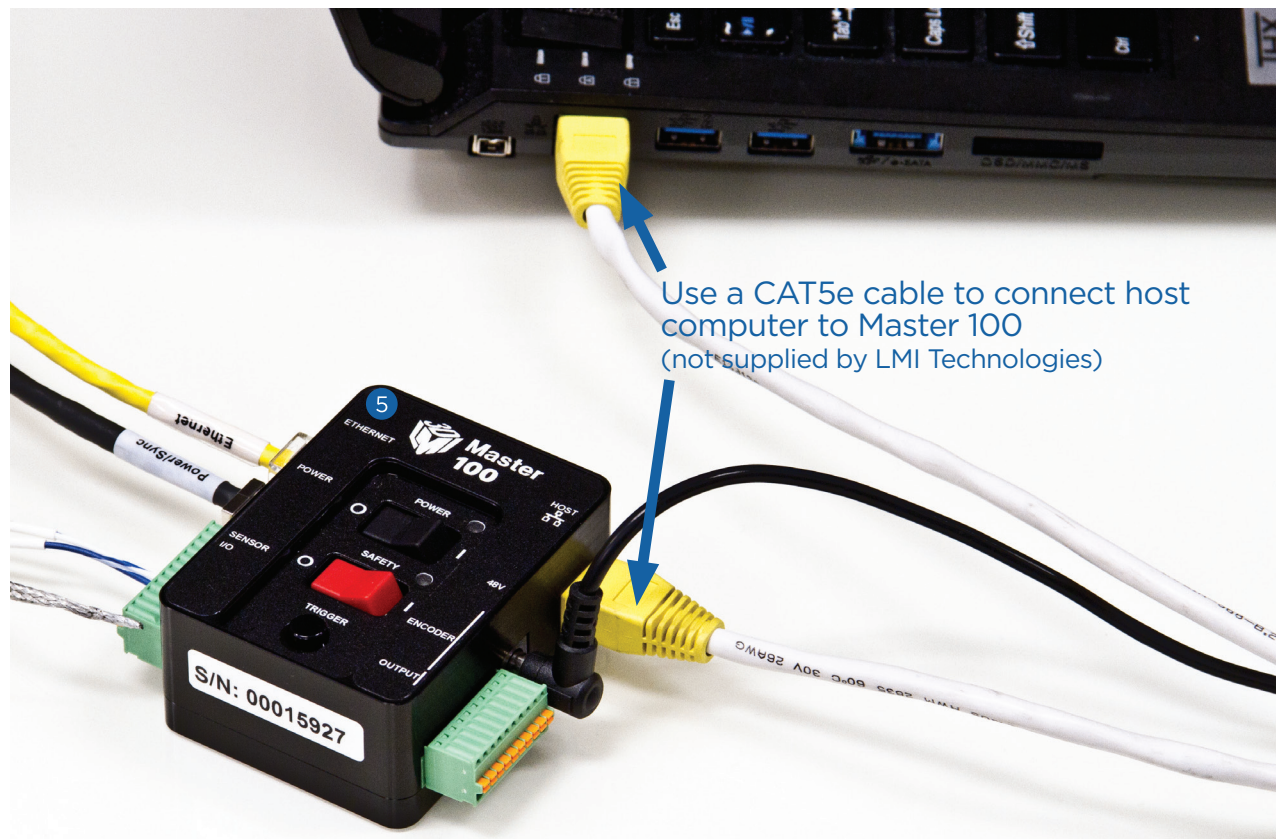

Power up the Scanner

- On the **Master 100** 5, turn on the Power (black rocker switch) and the Safety (red rocker switch).

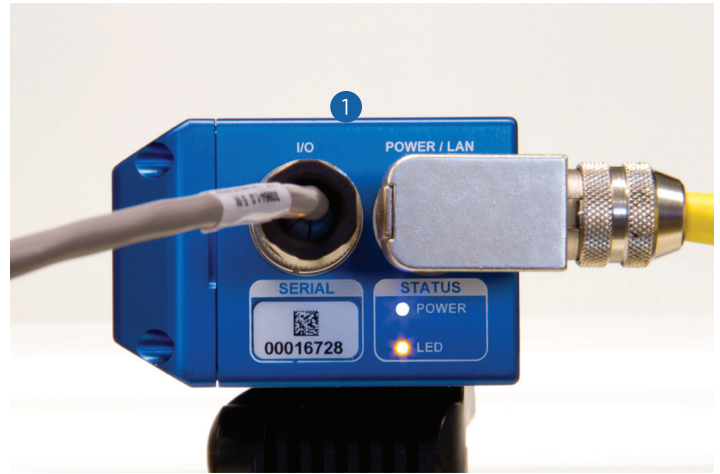

The Power and LED indicators should light once the Power and Safety switches have been turned on (Consult the User Manual for troubleshooting tips if these indicators remain unlit)

The physical assembly of the HDI 100 Series 3D Scanner is now complete

Next Steps - Installing FlexScan3D

NOTE: Refer to the FlexScan3D User's Guide for information on installing and using the FlexScan3D software at <http://manual.lmi3d.com>.

LMI Technologies, their partners, and resellers accept no liability for any damages (personal or to property) incurred as a result of improper use, incorrect assembly, failure to adhere to safety precautions, and/or mistreatment of this product (including its components).

